

MINI-SPOOLER

Used for Tensioning Hotcote® and Horsecote®

Installing the Two Piece Mini Spooler

A Mini Spooler Tensioner is used to complete tensioning of the fence without the need to strip, crimp or tie a knot.

Follow these easy steps to install and tension both electrifiable or non-conductive coated wire.

Prior to Installing the Mini Spooler

- Attach both ends of coated wire to the end posts. (for more details see the Hotcote® or Horsecote® – End Post Attachment for Coated Wire PDF)
- Attach coated wire to posts at major rises, dips and corners. (for more details see the Coated Wire Payout & Line Post Installation PDF)

Determine where to position the Mini Spooler

- On a flat terrain where there are no corners, provide one Mini Spooler per length of fence, placed in center.
- Where terrain is not flat or there are corners, more Mini Spoolers may be required.
 - Use one Mini Spooler for every 1,320' (402m) of coated wire and/or when 90° of elevation and directional change occur.
 - Corners, small dips and rises create friction so use one Mini Spooler for every accumulated 90°.

- 1 Place the Mini Spooler on the coated wire by first holding it up to the coated wire and then sliding the removable section into the appropriate slot. Keep 12" (305mm) to 18" (457mm) from line post.
- 2 Proper tensioning is accomplished by:
 - Making sure the coated wire is hand tight before final tensioning with Mini Spooler.
 - Having sufficient slack in the coated wire for one full rotation before becoming taut.
- 3 To make installation and tightening easier and safer, use the Extended Handle Ratchets. Place a ratchet on each Mini Spooler hub.

WARNING: Failure to fully engage hub may cause injury or damage to the Mini Spooler – voiding any Warranty!

NOTE: On outside corners use a length of coated wire tubing to insulate. For inside corners use an Inside Corner Roller.

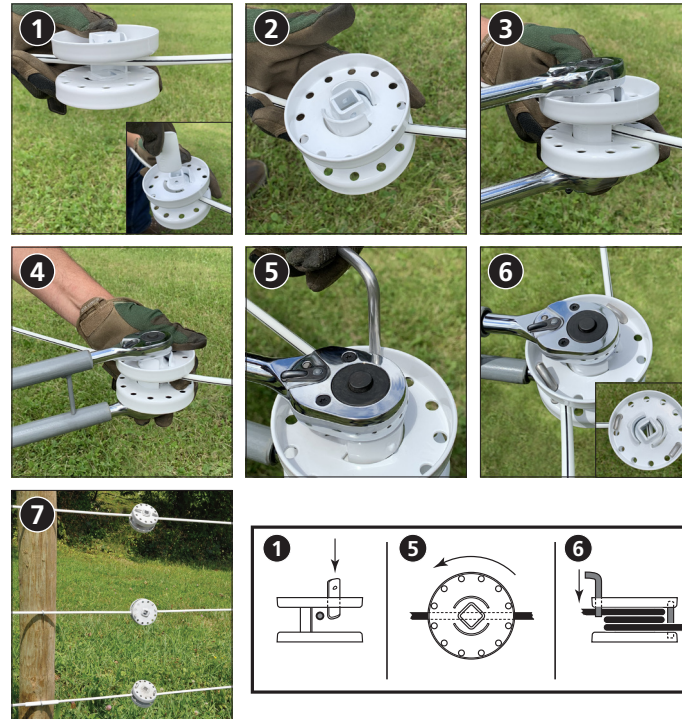

- 4 Slide on extended handles and remove the safety pin from the rubber strap.
- 5 Tension the coated wire by first ratcheting the Extended Handles (use the safety pin to hold the tension while ratcheting back) then remove safety pin, repeat ratcheting until taut.
- 6 Two locking pins MUST be placed opposite each other in holes closest to the tensioned coated wire.
- 7 Where there are multiple strands of coated wire, for best appearance, attempt to align vertically near a post.

Hardware is Double Coated for Superior Weather Resistance: E-Coat and Powder Coat

- **WARNING:** Only for use with low-impedance electric fence energizers!
- Always use an adequate number of electric fence warning signs and make sure to attach them securely.
- It's essential to keep fence line clear of all debris. Please do not burn!

Product

- Mini Spooler Tensioner
 - Colors: Brown, Black & White



Other Tools Needed

- Extended Handle Ratchets

Other Related PDF Sheets

- Joining Buckle
- End Post Attachment for Coated Wire
- Coated Wire Payout and Line Post Attachment

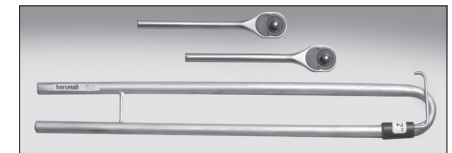

Extended Handle Ratchets

Use 2" (50mm) size for Mini Spoolers



horserail
Just...buckle it up!

horserail.com



SAFETY FIRST: USE SAFETY EYE GLASSES AND GLOVES.